

# A-Series

## Outlet Dimension / 外觀尺寸

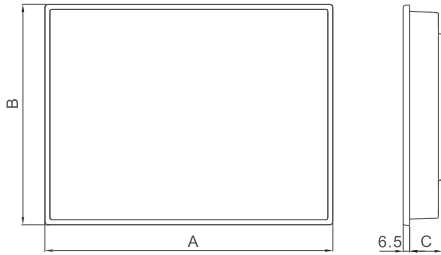

## Cut Out Dimension / 開孔尺寸

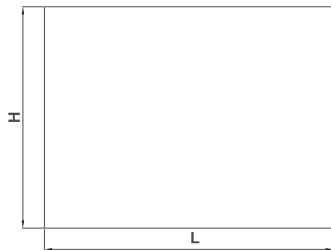

Model	A	B	C	L	H
PA043	130.0mm	106.2mm	39mm	119.0mm	93.0mm
PA070	203.5mm	149.0mm	33mm	192.0mm	138.5mm
PA100	270.1mm	212.1mm	42.5mm	259.5mm	201.5mm

1

## Power Supply / 電源供應

**Warning:** Powered by a Low Voltage / Limited Energy power source.  
以低電壓提供電力 / 限制能量電源。

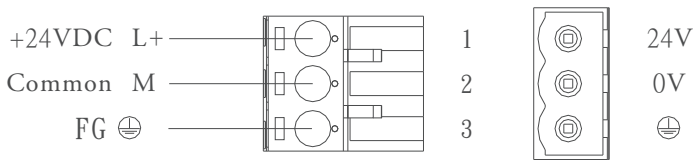

**Warning:** Do not open the rear cover of the panel when power is applied.  
電源送電時請勿開啟後殼。

**Warning:** Ensure that the power supply has enough power capacity for the operation of the equipment.  
送電時請確定電源設備的電源能力符合產品硬體規範。

## Function View / 功能配置圖

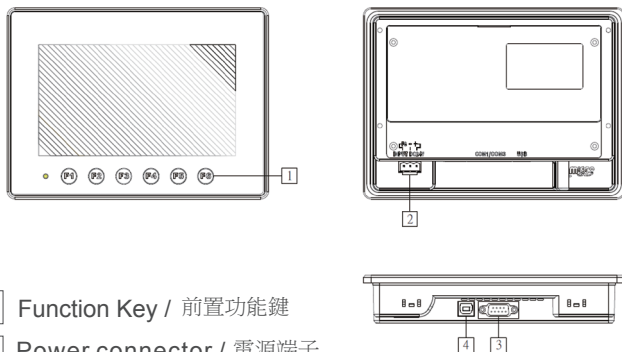

- 1 Function Key / 前置功能鍵
- 2 Power connector / 電源端子
- 3 COM1/COM3 9Pin Female / COM1/COM3 9Pin 母座
- 4 USB Client / USB接口

2

## Installation Drawing / 安裝示意圖

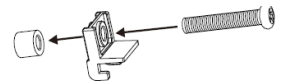
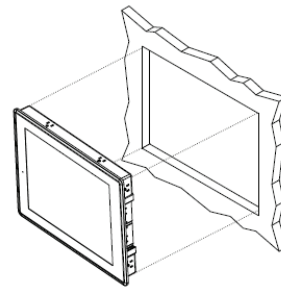

Fix Screw / 固定螺絲

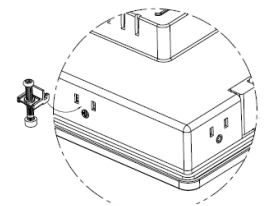

**Warning:** Screw each fixing screw until the bezel corner gets in contact with the panel.  
使用固定螺絲固定時請注意不要鎖太緊，以避免壓迫造成其他問題。

## Dispose of batteries / 電池處置

Model	CR 2032 (Removable)
System	Manganese dioxide-Li/Organic Electrolyte
Nominal Voltage	3V
Nominal Capacity	220mAh
Nominal Discharge Current	0.2 mA
Operating Temperature Range	-20 to +85(°C)
Weight	3.0 g
Dimensions	
Diameter	20.0 mm
Height	3.2 mm
UL Recognition	MH 12568

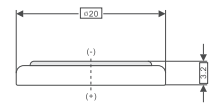

## Battery / 電池

Maxcell/Panasonic 3V 220mAh Lithium Coin Battery type.

**Warning:** Dispose of batteries according to local regulations.  
廢棄電池的處置請依據使用者所在地對廢棄電池處置方式辦理。

3

## Pin Assignment of Serial Port / 串口接腳定義 (序列埠接腳定義)

COM1/COM3 9Pin Female / COM1/COM3 9Pin 母座			
Pin	Com1	Pin	Com3
1	RS-422 TXD+ / RS-485+	7	RS-232 TXD
2	RS-232 RXD	8	RS-232 RXD
3	RS-232 TXD		
4	RS-422 RXD+		
5	SG		
6	RS-422 TXD- / RS-485-		
9	RS-422 RXD-		

The products have been designed for use in an industrial environment in compliance with the 2004/108/EC directive.

本產品適用於工業環境並符合2004/108/EC規範。

The products have been designed in compliance with:

本產品符合以下法規:

EN 61000-6-2	EN 61000-4-2
EN 61000-6-4	EN 61000-4-3
	EN 61000-4-4
	EN 61000-4-5
	EN 61000-4-6
	EN 61000-4-8
	EN 61000-4-11

The installation of these devices into the residential, commercial and light-industrial environments are allowed only in the case that special measure are taken in order to get the conformity to IEC-61000-6-3

本產品若要安裝於住宅空間或商業及輕工業的環境時，必需加測特殊檢驗以符合IEC-61000-6-3

Reproduction of the contents of this copyrighted document, in whole or part without written permission of Cermate Technologies Inc., is prohibited.

本文件內容版權為Cermate Technologies Inc.所有,非經本公司同意,請勿自行重製、拷貝或修正文件內容。

4